

Contest Pattern
QUARTET SEMIFINALS
September 21, 2018

	PERFORMER	WALK-ON	WARM-UP ROOM *	Transition	BACK STAGE	ON STAGE	PHOTO ROOM
	OPENING - INTRODUCTION	3:00 PM				7:00 PM	
MT	Cairn - Colorado Springs/Pikes Peak, CO	3:00 PM	Rm A - 6:36 PM	6:55 PM	7:00 PM	7:04 PM	7:12 PM
1	The Four Tunesmen - Golden Spike, UT	3:20 PM	Rm B - 6:44 PM	7:03 PM	7:08 PM	7:12 PM	7:20 PM
2	4th Street - Salt Lake City, UT	3:26 PM	Rm C - 6:52 PM	7:11 PM	7:16 PM	7:20 PM	7:28 PM
3	Final Approach - Denver Mile High & Denver North Metro, CO	3:32 PM	Rm A - 7:00 PM	7:19 PM	7:24 PM	7:28 PM	7:36 PM
4	Ante Up - Bernalillo, NM & Wasatch Front, UT	3:38 PM	Rm B - 7:08 PM	7:27 PM	7:32 PM	7:36 PM	7:44 PM
5	Landlocked - Denver Mile High, CO	3:44 PM	Rm C - 7:16 PM	7:35 PM	7:40 PM	7:44 PM	7:52 PM
6	Fastlane - Denver Mile High & Mountainaires, CO	3:50 PM	Rm A - 7:24 PM	7:43 PM	7:48 PM	7:52 PM	8:00 PM
7	Velcro - Colorado Springs/Pikes Peak & Colorado Springs Metro, CO	3:56 PM	Rm B - 7:32 PM	7:51 PM	7:56 PM	8:00 PM	8:08 PM
8	Average Joes - Wasatch Front, UT & Greater Phoenix, AZ	4:02 PM	Rm C - 7:40 PM	7:59 PM	8:04 PM	8:08 PM	8:16 PM
	INTERMISSION					8:16 PM	
9	Continuum - Denver Mile High, CO	4:08 PM	Rm A - 8:03 PM	8:22 PM	8:27 PM	8:31 PM	8:39 PM
10	Brass Rail - Albuquerque & Bernalillo County, NM	4:14 PM	Rm B - 8:11 PM	8:30 PM	8:35 PM	8:39 PM	8:47 PM
11	Naturally Aged - Longmont, CO	4:20 PM	Rm C - 8:19 PM	8:38 PM	8:43 PM	8:47 PM	8:55 PM
12	Maelstrom - Denver Mile High, CO	4:26 PM	Rm A - 8:27 PM	8:46 PM	8:51 PM	8:55 PM	9:03 PM
13	NightFall - Bernalillo County, NM	4:32 PM	Rm B - 8:35 PM	8:54 PM	8:59 PM	9:03 PM	9:11 PM
14	Sound Check - Wasatch Front & Utah Valley, UT	4:38 PM	Rm C - 8:43 PM	9:02 PM	9:07 PM	9:11 PM	9:19 PM
15	Scraps - Salt Lake City, UT	4:44 PM	Rm A - 8:51 PM	9:10 PM	9:15 PM	9:19 PM	9:27 PM
16	Shaken & Stirred (mixed) - Denver, CO	4:50 PM	Rm B - 8:59 PM	9:18 PM	9:23 PM	9:27 PM	9:35 PM
	Announcements - Contest Administrator(s)					9:37 PM	
	Quartet Finalist (Top 10 + MT)						
	CLOSING					9:43 PM	
	Eliminated Quartet Evals @ Marriott (HQ)					10:15 PM	
	Quartets Placing 11-15 + Shaken & Stirred (10 minutes per judge)						
	Evals Complete					11:15 PM	

* See venue floor plan

Rm A - Ent Center / Room #153
Rm B - Ent Center / Room #145
Rm C - Ent Center / Room #136
Rm D - Ent Center / Margot Lane Studio
Rm E - Ent Center / Chapman Recital Hall
PHOTO ROOM - Ent Center / Loading Bay

Contest Pattern
QUARTET FINALS / SHOW OF CHAMPIONS
September 22, 2018

	PERFORMER	WARM-UP ROOM *	Transition	BACK STAGE	ON STAGE
	OPENING - INTRODUCTION				6:00 PM
MT		Rm A - 5:36 PM	5:55 PM	6:00 PM	6:04 PM
1		Rm B - 5:44 PM	6:03 PM	6:08 PM	6:12 PM
2		Rm C - 5:52 PM	6:11 PM	6:16 PM	6:20 PM
3		Rm A - 6:00 PM	6:19 PM	6:24 PM	6:28 PM
4		Rm B - 6:08 PM	6:27 PM	6:32 PM	6:36 PM
5		Rm C - 6:16 PM	6:35 PM	6:40 PM	6:44 PM
6		Rm A - 6:24 PM	6:43 PM	6:48 PM	6:52 PM
7		Rm B - 6:32 PM	6:51 PM	6:56 PM	7:00 PM
8		Rm C - 6:40 PM	6:59 PM	7:04 PM	7:08 PM
9		Rm A - 6:48 PM	7:07 PM	7:12 PM	7:16 PM
10		Rm B - 6:56 PM	7:15 PM	7:20 PM	7:24 PM
	INTERMISSION				7:32 PM
	Announcements - Contest Administrator(s)				7:47 PM
	Fall District Novice Champion				
	Int'l Senior Quartet Rep				
	District Quartets: 3rd Place, 2nd Place & Champions				
	SHOW OF CHAMPIONS				8:00 PM
	America The Beautiful Chorus (1 song)		7:55 PM	8:00 PM	8:05 PM
	2017 District Quartet Champions - Swan song (1 song)	Rm A - 7:46 PM	8:05 PM	8:10 PM	8:15 PM
	2018 International Quartet Representatives (1 song each)	Rm B - 7:51 PM	8:10 PM	8:15 PM	8:20 PM
	2018 District Seniors Quartet Representative (1 song)	Rm C - 8:06 PM	8:25 PM	8:30 PM	8:35 PM
	Velvet Hills Sweet Adeline Chorus	Rm D - 8:16 PM	8:35 PM	8:40 PM	8:45 PM
	Summit Singers - Kim Shultz - High Schoolers	Rm E - 8:31 PM	8:50 PM	8:55 PM	9:00 PM
	2018 District Quartet Champions (2 songs)	Rm A - 8:41 PM	9:00 PM	9:05 PM	9:10 PM
	2018 District Chorus Champion (2 songs)	Rm D - 8:51 PM	9:10 PM	9:15 PM	9:20 PM
	CLOSING				9:30 PM
	Finalist Quartet Evals @ Marriott (HQ) (20 minutes per judge)				10:00 PM
	Evals Complete				12:00 AM

* See venue floor plan

Rm A - Ent Center / Room #153
Rm B - Ent Center / Room #145
Rm C - Ent Center / Room #136
Rm D - Ent Center / Margot Lane Studio
Rm E - Ent Center / Chapman Recital Hall

Contest Pattern
Drive from Marriott to Ent Center
September 21 & 22, 2018

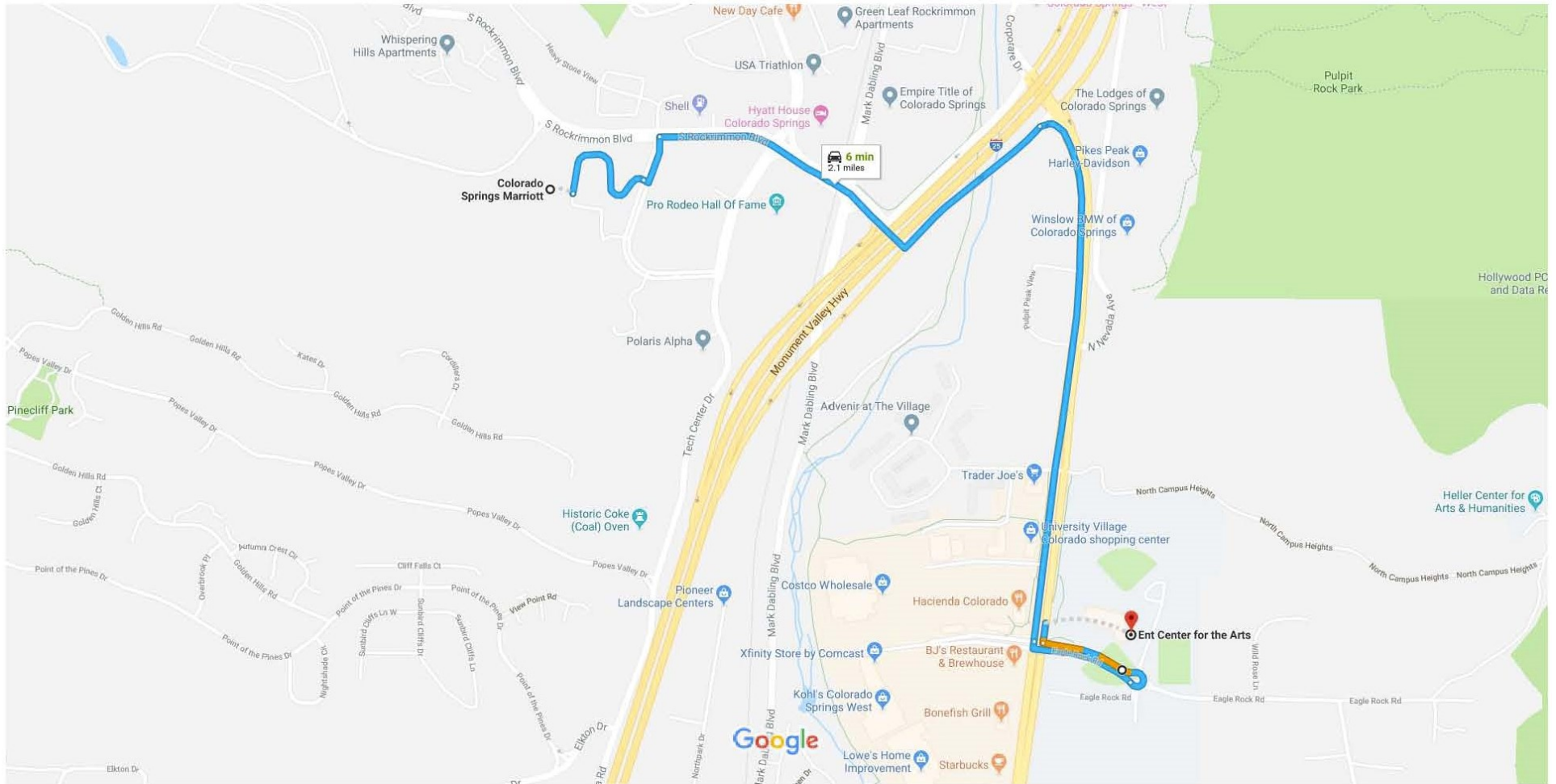

Contest Pattern
QUARTET SEMI-FINALS & FINALS
September 21 & 22, 2018

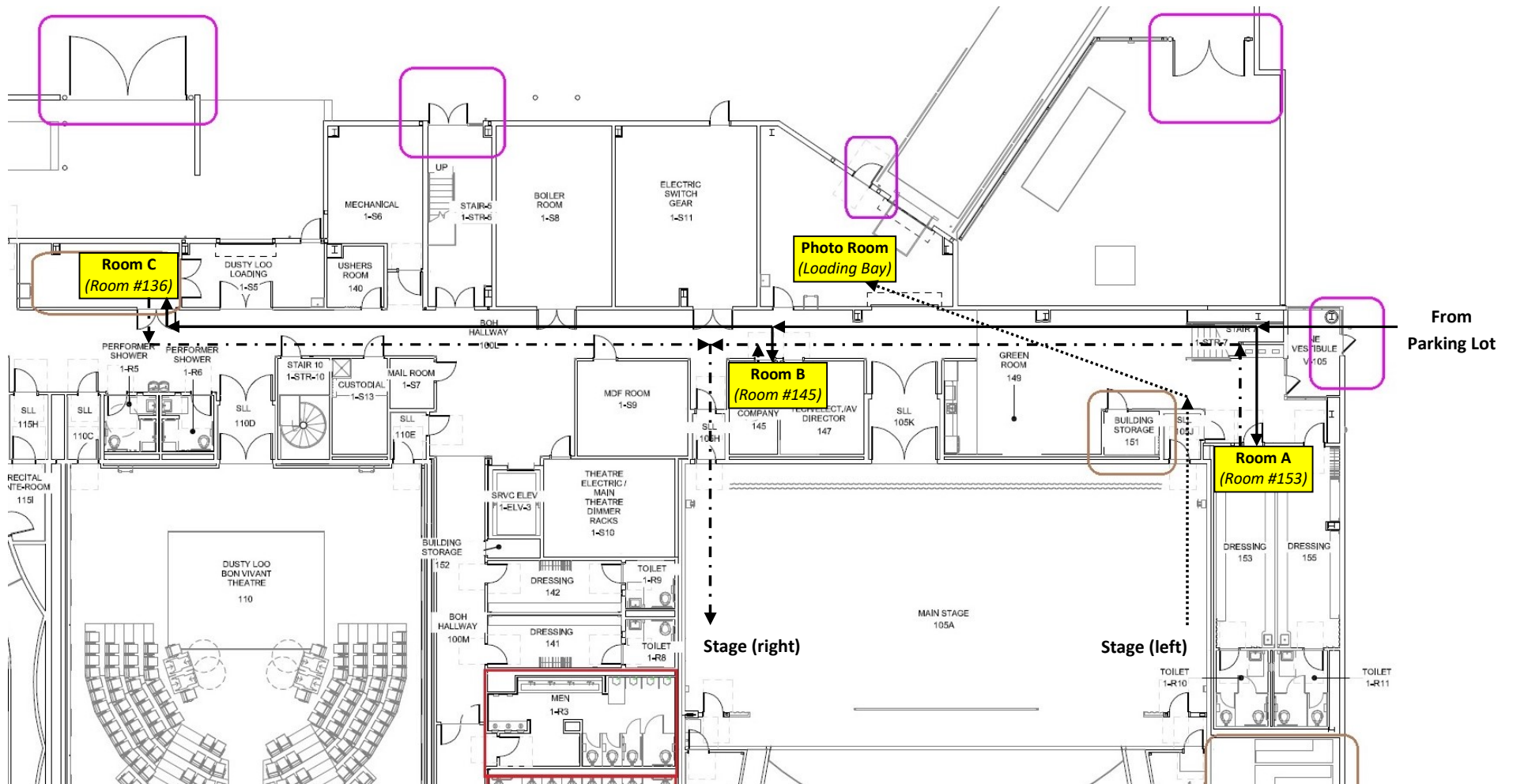

- Key:
- ← To Room
 - ⬅ To Stage
 - ⋯ To Photo